

PROJET  
**Tôlerie**  
POSTSECONDAIRE

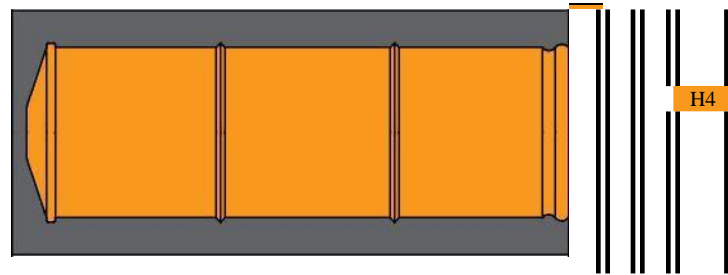

LECTURE



dessiné par Paul Lavigne 2017

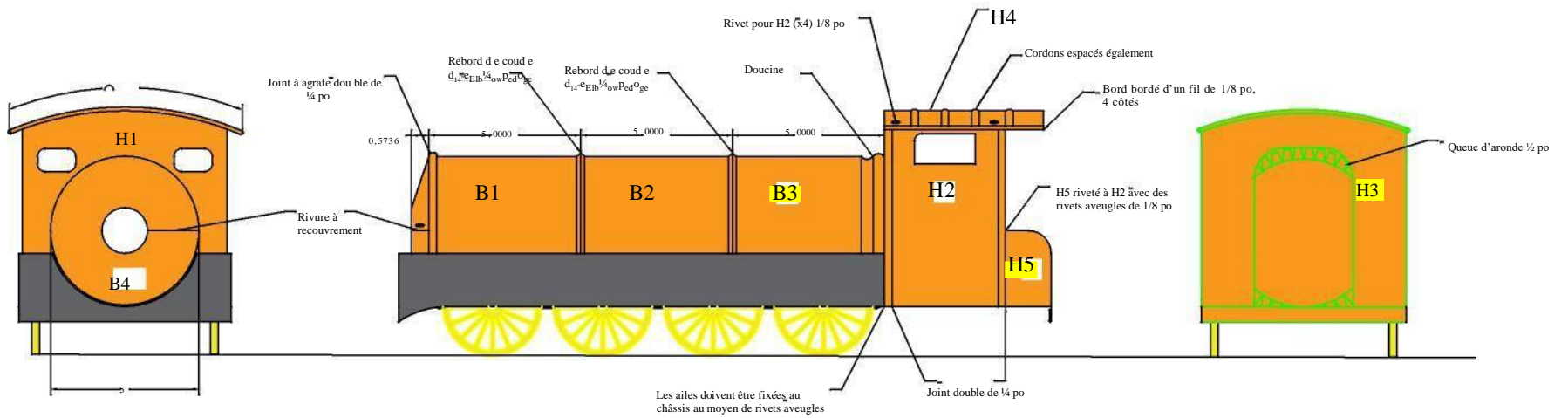

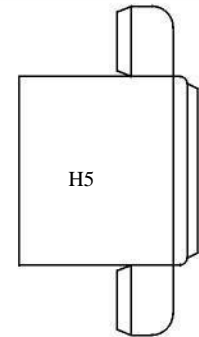
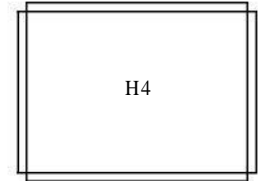
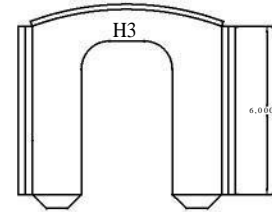
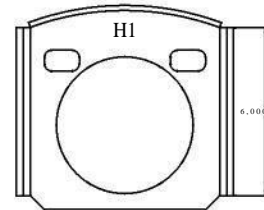
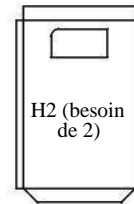
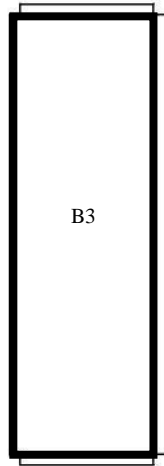
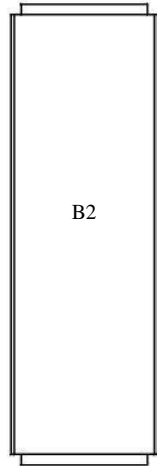
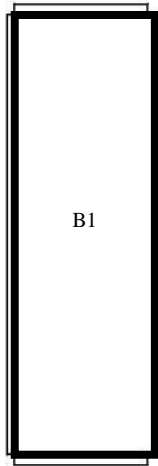
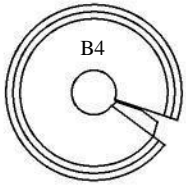
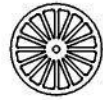
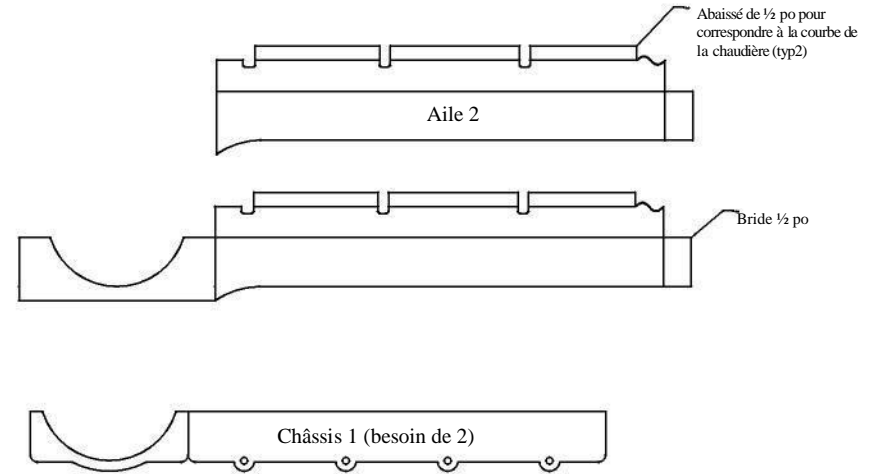

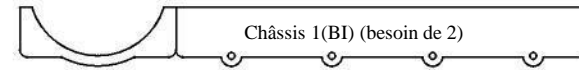
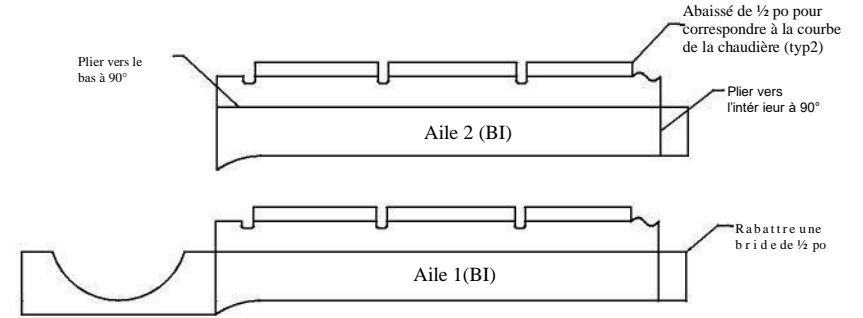
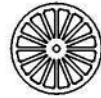

Pièce mâle, tolérance pour joint double de 1/4 po

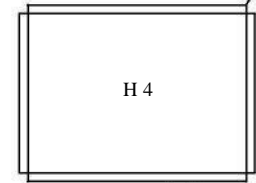
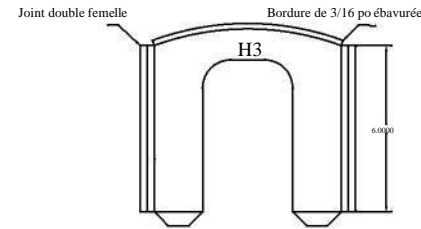
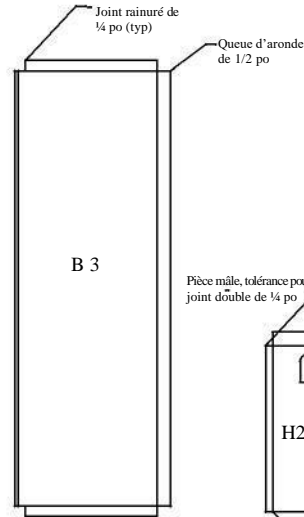
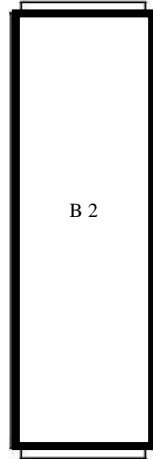
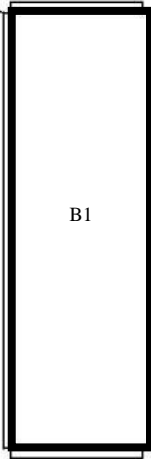
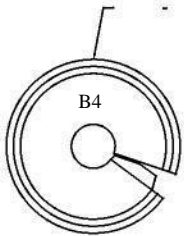

Pièce mâle, tolérance pour joint double de 1/4 po

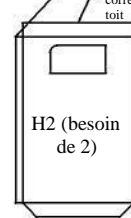

Rabattre la bride de 1/2 po pour correspondre à la courbe du toit

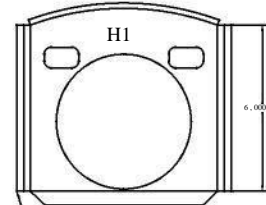

Pièce femelle, tolérance pour joint double de 1/4 po

Rabattre une bride de 1/2 po à 90°

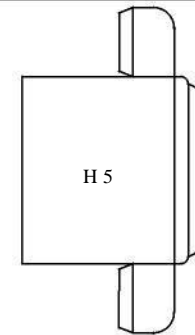

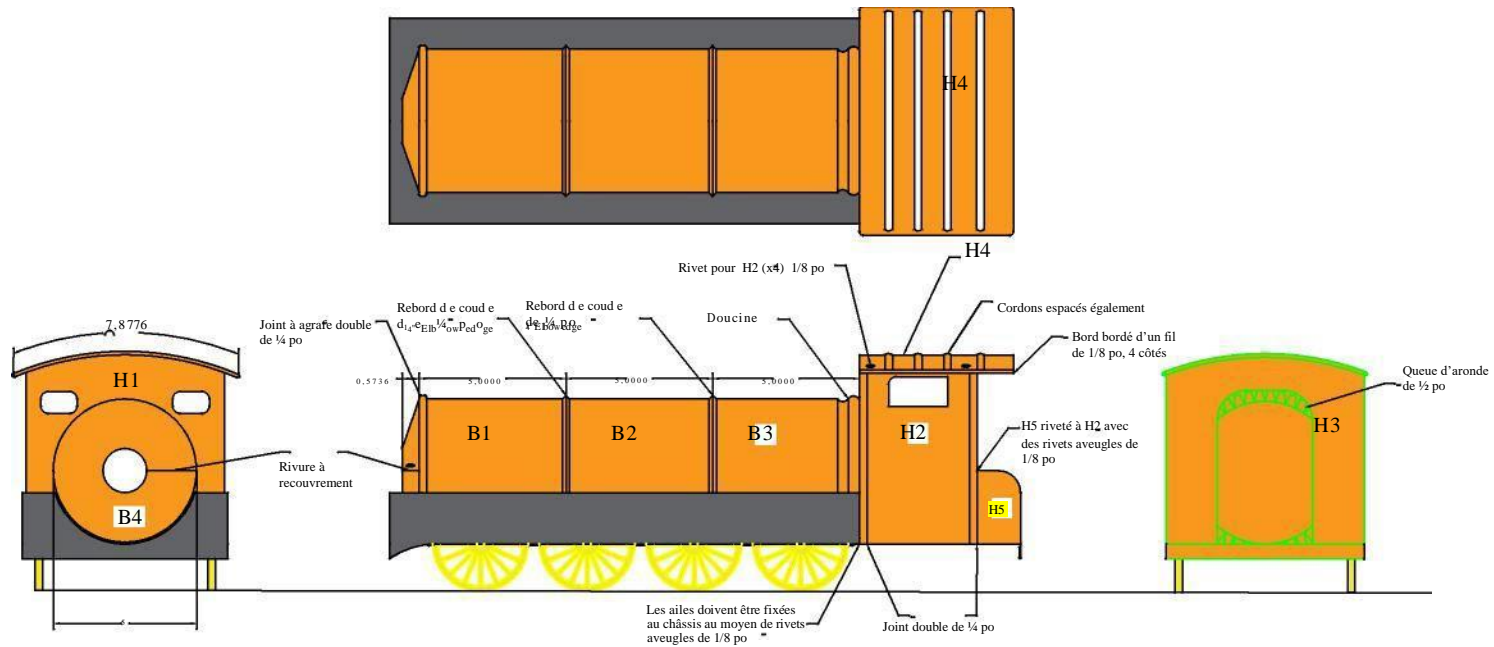

LECTURE